



# AR 115 bp - AR 135 bp - AR 115 bp/1000 giri-rpm

	C		SP	
	NBR	BLUEFLEX	NBR	BLUEFLEX
AR 115 bp	1203	32014	1204	32015
AR 115 bp/1000	1199	-	-	-
AR 135 bp	1206	32024	1207	32025

Bassa pressione  
Low pressure

Pos	Cod.	Descrizione	Description	Q.ty	Note
1	580013	Corpo pompa	Pump body	1	
2	580150	Condotto	Line	1	
3	550101	Testa dx	Head	2	
4	550102	Testa sx	Head	1	
5	180152	Dado M10	Nut	3	Geomet C <sub>40</sub>
6	550081	Membrana	Diaphragm	3	BlueFlex™
7	550080	Membrana	Diaphragm	3	NBR
8	550084	Membrana	Diaphragm	3	Viton
9	550086	Membrana	Diaphragm	3	HPDS
10	580110	Camicia	Sleeve	3	AR115bp
11	580350	Camicia	Sleeve	3	AR135bp
12	580112	Camicia	Sleeve	3	AR115bp/1000
13	500260	Segmento	Piston ring	3	
14	580120	Pistone Ø 80	Piston	3	
15	380300	Spina	Pin	3	▶
16	380080	Anello seeger Øi 14	Ring	6	
17	580140	Biella	Connecting-rod	3	▶
18	320030	Guarnizione OR Ø 31,5x4,5	O-ring	6	90Sh ☒
19	759051	Valvola	Valve	6	AR115bp AR135bp
20	589050	Valvola	Valve	6	AR115bp/1000
21	540541	Girello 1" 3/4 G	Ring nut	1	
22	390291	Guarnizione OR Ø 28,25x2,62	O-ring	7	☒
23	540530	Raccordo 1"1/4G-1"3/4GM-M	Fitting	1	
24	390271	Dado M8	Nut	3	Geomet C <sub>20</sub>
25	580050	Guarnizione	Gasket	1	▶
26	580180	Semicamera aria inferiore	Semi air chamber	1	Nera
27	550194	Membrana camera aria	Diaphragm	1	Blueflex™
28	550190	Membrana camera aria	Diaphragm	1	NBR
29	550192	Membrana camera aria	Diaphragm	1	Viton
30	550193	Membrana camera aria	Diaphragm	1	HPDS
31	550233	Semicamera aria superiore	Semi air chamber	1	Nera
32	550300	Valvola di gonfiaggio	Air valve	1	C <sub>3</sub>
33	650542	Guarnizione	Gasket	1	
34	550680	Vite TE M8x20	Screw	4	Geomet C <sub>20</sub>
35	200391	Anello seeger Øi 62	Ring	1	
36	550470	Bussola anello tenuta	Bushing	1	
37	550070	Rondella	Washer	1	
38	550060	Boccola	Bushing	1	↓
39	550170	Albero marcato AL	Shaft	1	AR115bp SP
40	580380	Albero marcato AT	Shaft	1	AR135bp SP
41	580470	Anello biella	Ring	2	▶
42	551040	Vite TE M10x55	Screw	12	Geomet
43	550310	Boccola	Bushing	1	↓
44	550340	Raccordo 1" G M-M	Fitting	1	
45	550350	Guarnizione OR Ø 23,81x2,62	O-ring	1	☒
46	550242	Girello 1" G	Ring nut	1	
47	550370	Curva Ø 25	Elbow	1	
48	540550	Curva Ø 40	Elbow	1	
49	250310	Guarnizione OR Ø 36,14x2,62	O-ring	2	☒

Pos	Cod.	Descrizione	Description	Q.ty	Note
53	550491	Anello tenuta	Ring	1	☒
54	650920	Guarnizione OR Ø 53,65x2,62	O-ring	1	☒
55	880530	Tappo 3/8" G	Plug	1	C <sub>20</sub>
56	330173	Tappo 1/2" G	Plug	1	Geomet C <sub>20</sub>
57	580072	Raccordo	Fitting	1	
58	1500350	Protezione cardano	Cardan protection	1	
59	550332	Rondella	Washer	2	Geomet
60	320621	Rondella	Washer	5	Geomet
61	740290	Guarnizione OR Ø 14x1,78	O-ring	1	▶
62	550173	Albero marcato AM	Shaft	1	AR115bp C
63	580330	Albero marcato AS	Shaft	1	AR135bp C
64	550176	Albero marcato AP	Shaft	1	AR115bp/1000
65	580370	Piattello foro Ø 14	Wobble plate	3	(b)
66	580360	Perno	Hub pin	3	(b) C <sub>20</sub>
67	580080	Piede	Foot	1	AR115bp AR135bp
68	580082	Piede	Foot	1	AR115bp/1000
69	540301	Vite TCEI M10x30	Screw	1	Geomet C <sub>40</sub>
70	580400	Raccordo	Fitting	2	
71	550460	Curva Ø 18	Elbow	1	
72	550450	Girello 3/4" G	Ring nut	1	
73	880831	Guarnizione OR Ø 15,54x2,62	O-ring	1	Viton ▶
74	1609000	Valvola di sicurezza	Safety valve	1	20 bar ■
75	881560	Raccordo 1/2" G M-F	Fitting	1	■
76	580421	Raccordo M-F 1/2"	Fitting	1	C <sub>20</sub>
77	180101	Guarnizione OR Ø 17,5x2	O-ring	1	
78	850851	Vite TCEI M6x30	Screw	2	Geomet C <sub>10</sub>
79	620472	Vite TCEI M10x20	Screw	3	Geomet C <sub>10</sub>
80	390180	Guarnizione OR Ø 18,72x2,62	O-ring	1	▶
81	1040310	Serbatoio	Tank	1	
82	650920	Guarnizione OR Ø 53,65x2,62	O-ring	1	
83	1040322	Tappo nero	Plug	1	AR115bp
84	1040320	Tappo rosso	Plug	1	AR135bp
85	1040321	Tappo verde	Plug	1	AR115bp/1000
86	2240110	Dado M10	Nut	3	(a) C <sub>30</sub>
87	2240100	Perno	Hub pin	3	(a) ■ C <sub>30</sub>
88	580371	Piattello foro Ø 10	Wobble plate	3	(a)

- @ Posizione targa di identificazione.  
Pump and manufacturer identification.
- (a) Da matricola N° 5821140001.  
From serial number 5821140001.
- (b) Fino a matricola N° 5820149999.  
Up to serial number 5820149999.

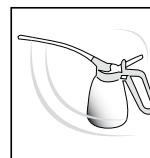

Olio utilizzato Suggested oil	
Tipo - Type	Kg
Pompa-Pump SAE 30	1

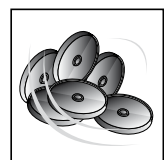

KIT 43085 Membrane BlueFlex BlueFlex diaphragms	
KIT 2367 Membrane NBR NBR diaphragms	
KIT 2368 Membrane HPDS HPDS diaphragms	
KIT 2369 Membrane Desmopan Desmopan diaphragms	
Pos.	Q.ty
8	3

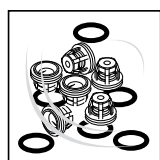

KIT 2370 AR115bp - AR135bp Valvole - Valves	
Pos.	Q.ty
16	6
17	6

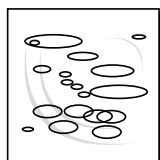

KIT 2026 OR O-Rings	
Pos.	Q.ty
16	6
19	7
29	1
47	1
52	1
54	1
66	1
81	1
83	1

KIT 43131 (a) AR115bp - AR135bp				Pronto intervento membrane in BlueFlex™ Maintenance repair BlueFlex™ diaphragms			
Pos.	Q.ty	Pos.	Q.ty	Pos.	Q.ty	Pos.	Q.ty
8	3	23	1	49	1	82	1
16	6	26	1	50	1	83	1
17	6	29	1	52	1	84	1
18	1	46	1	53	1	85	1
19	7	47	7	54	1	86	1
20	1	48	1	81	1	87	1

KIT 2025 (b) AR115bp - AR135bp				Pronto intervento membrane in NBR - Vecchia versione Maintenance repair buna diaphragms - Old version			
Pos.	Q.ty	Pos.	Q.ty	Pos.	Q.ty	Pos.	Q.ty
8	3	23	1	49	1	65	1
16	6	26	1	50	1	81	1
17	6	29	1	52	1	82	1
18	1	46	1	53	1	83	1
19	7	47	7	54	1	84	1
20	1	48	1	64	1		